

Obstacle Pattern Classes 7, 11, 15, 19

- 7. Walk & wheel Obstacle
- 11. Walk/Log/Trot/Obstacle
- 15. Walk/Jog/Trot Obstacle
- 19. Walk/Jog/Trot Obstacle

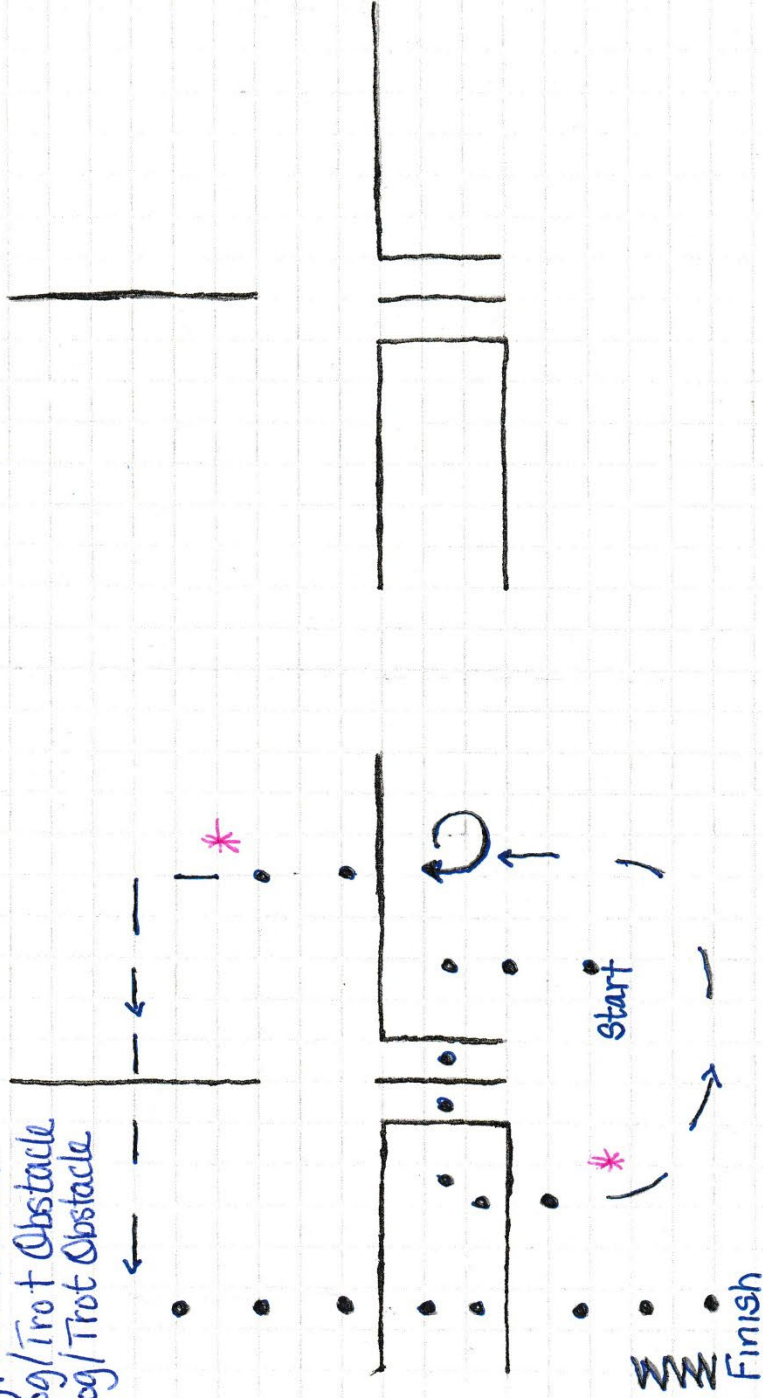

* Class 7 walk where it calls for a Trot.
Walk in over 3 logs.

Walk over and out of Chute.
Trot to Next log, stop, do 360 Right
Walk over log, trot and over the
next log.
Walk to and over the next two logs
Stop and BACK.

Trail Area

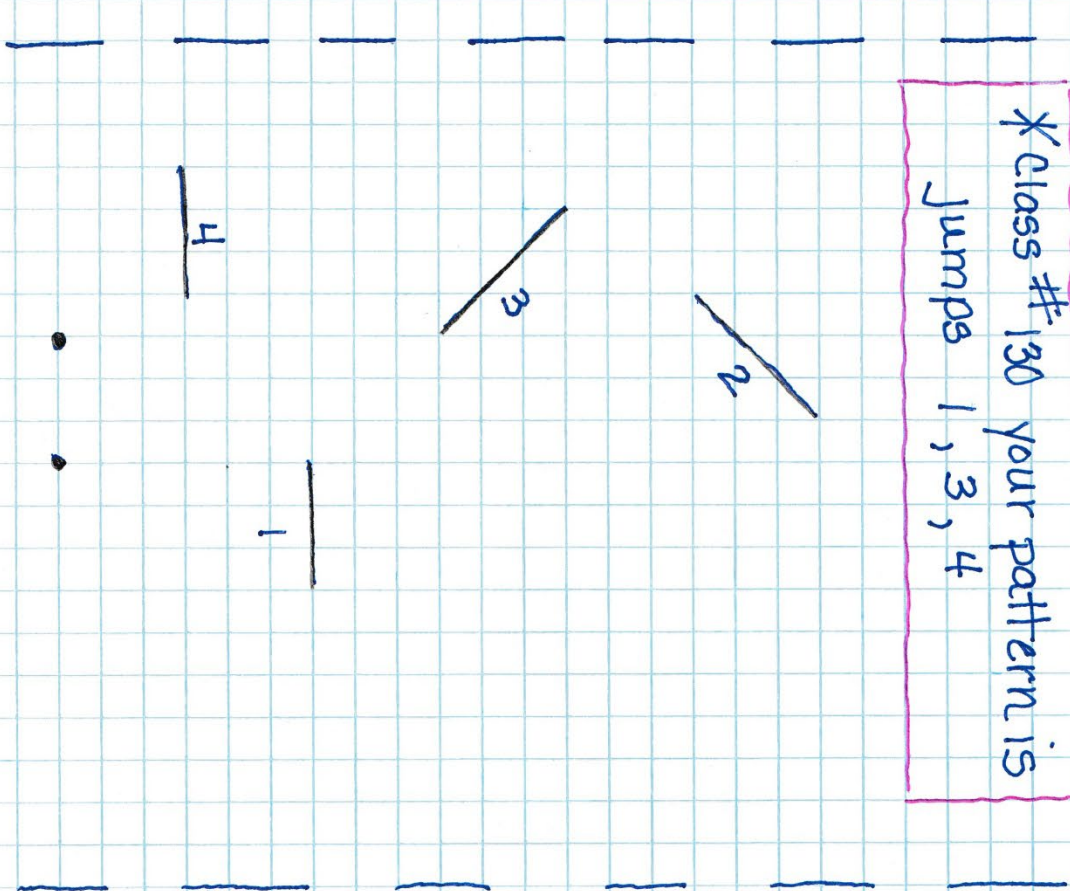

Classes #130, 135, and 140
*Class #130 your pattern is
jumps 1, 3, 4

Holding Pen

Classes 21, 25, 37
59, 63

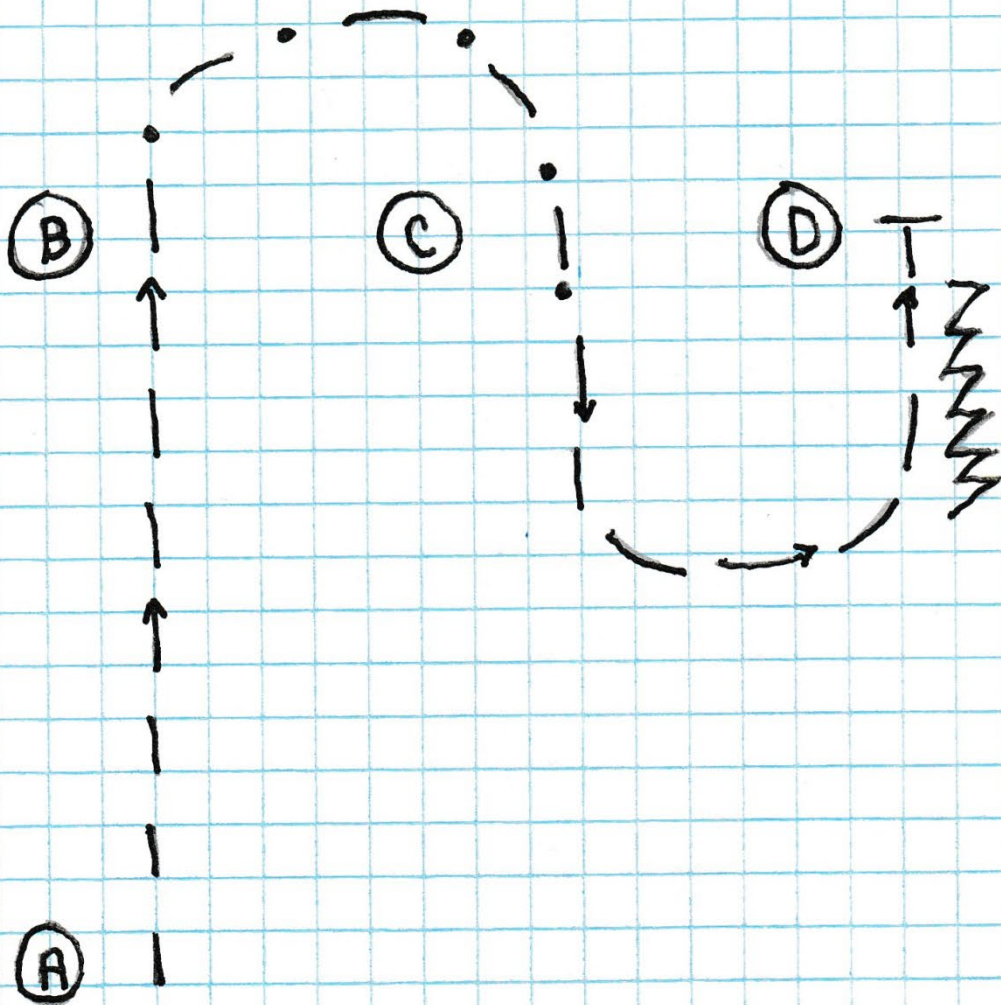

1. (Western) Extended Jog from A to B (English) Rising Trot A to B (Right Diagonal)
2. (Western) Regular Jog from B to C (English) Sitting trot B to C.
3. (Western) Extended jog from C to D (English) Rising Trot C to D (Left Diagonal)
4. Stop at D back one horse length

Classes 29, 33
41

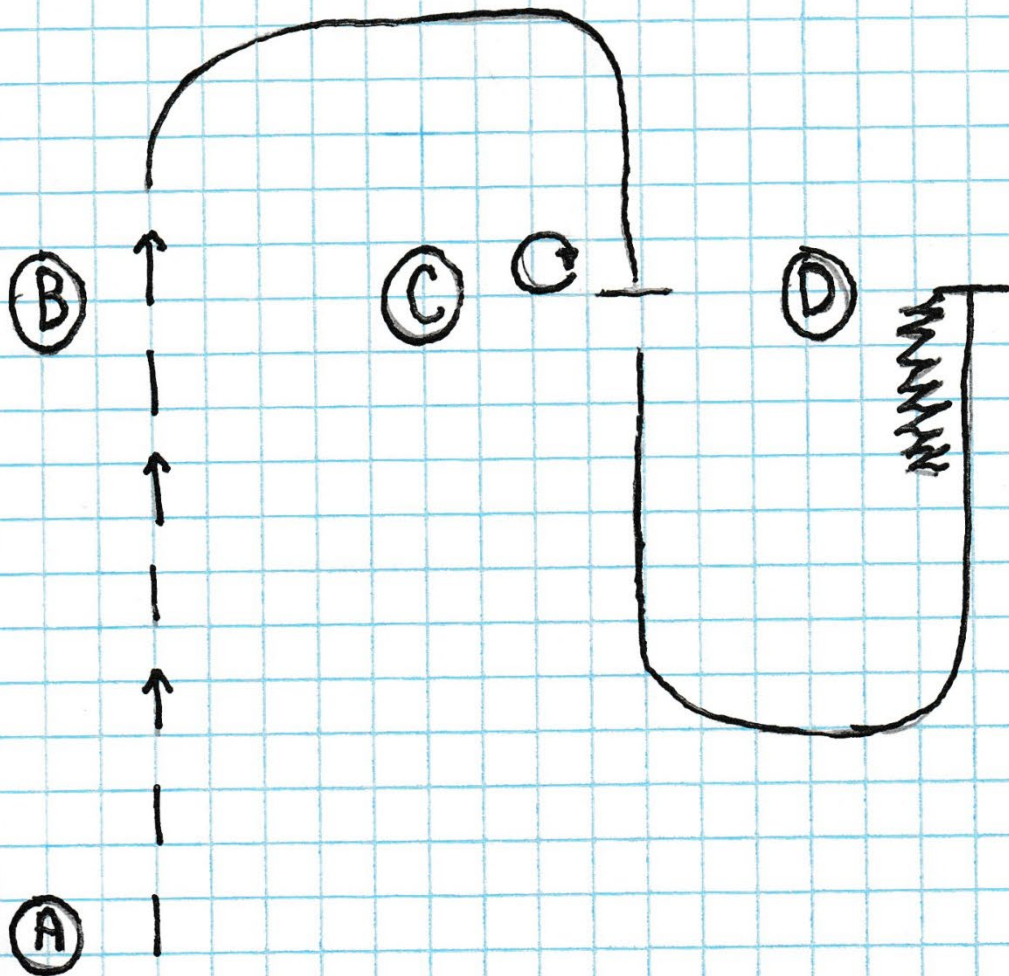

1. (Western) Extended jog A to B (English) Rising Trot from A to B (Right Diagonal)
2. Lope or Canter right lead B to C, stop
3. At C do a 360 right
4. Lope or Canter Left Lead from C to D, Stop back one horse length

Trail Area Classes 114, 118, 122, 134, 139

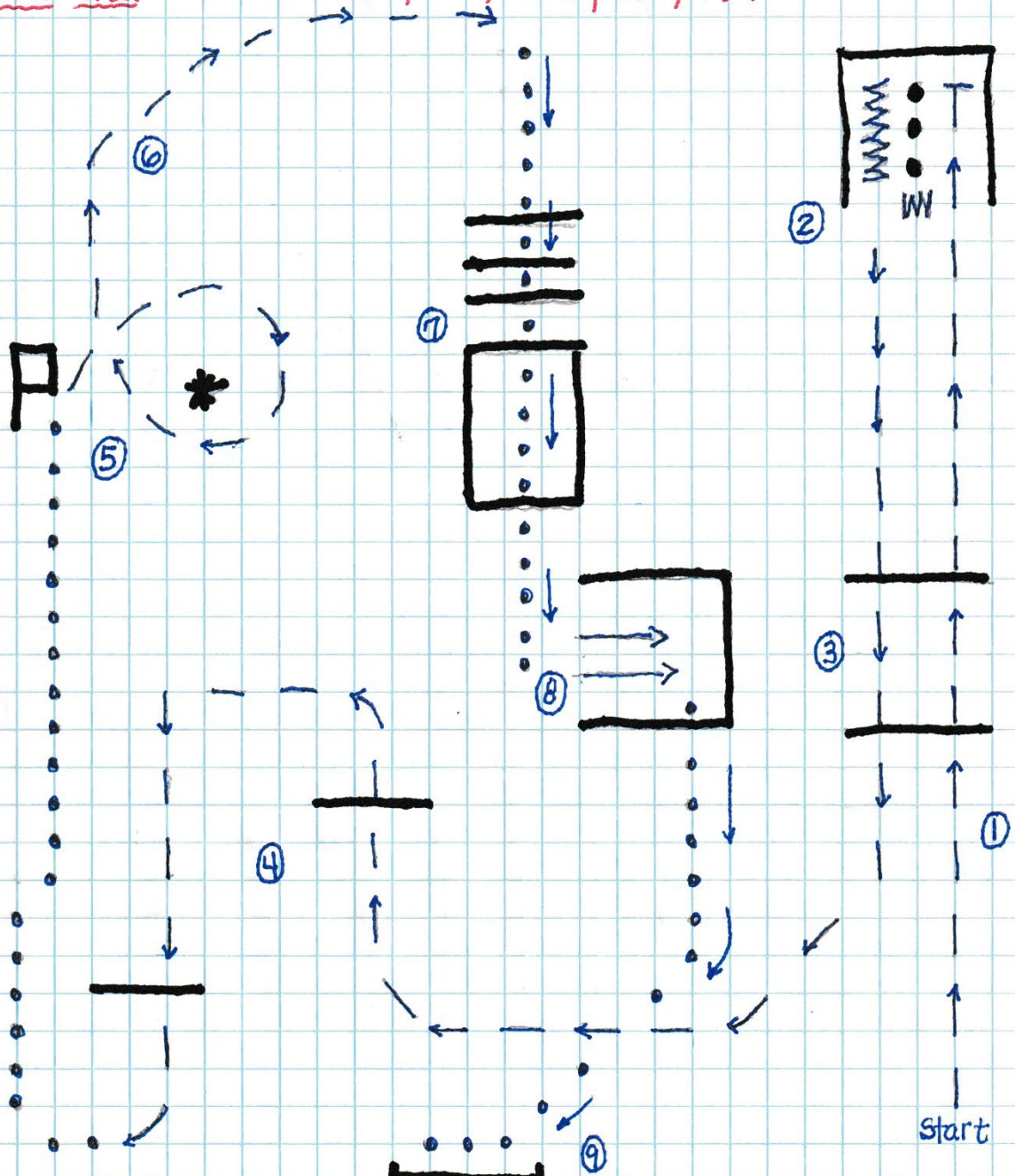

●●● WALK
 --- Trot
 ⇨⇨⇨ Sidepass
 W W W Back

1. Trot into chute
2. Back into other side
3. Trot Poles
4. Trot over poles, walk to mail box.
5. Show mail, trot circle around flowers.
6. Trot to poles
7. WALK over poles, Bridge
8. Sidepass LEFT walk out
9. WALK to gate work L gate

Trail Area Classes: 106, 110, 126, 129

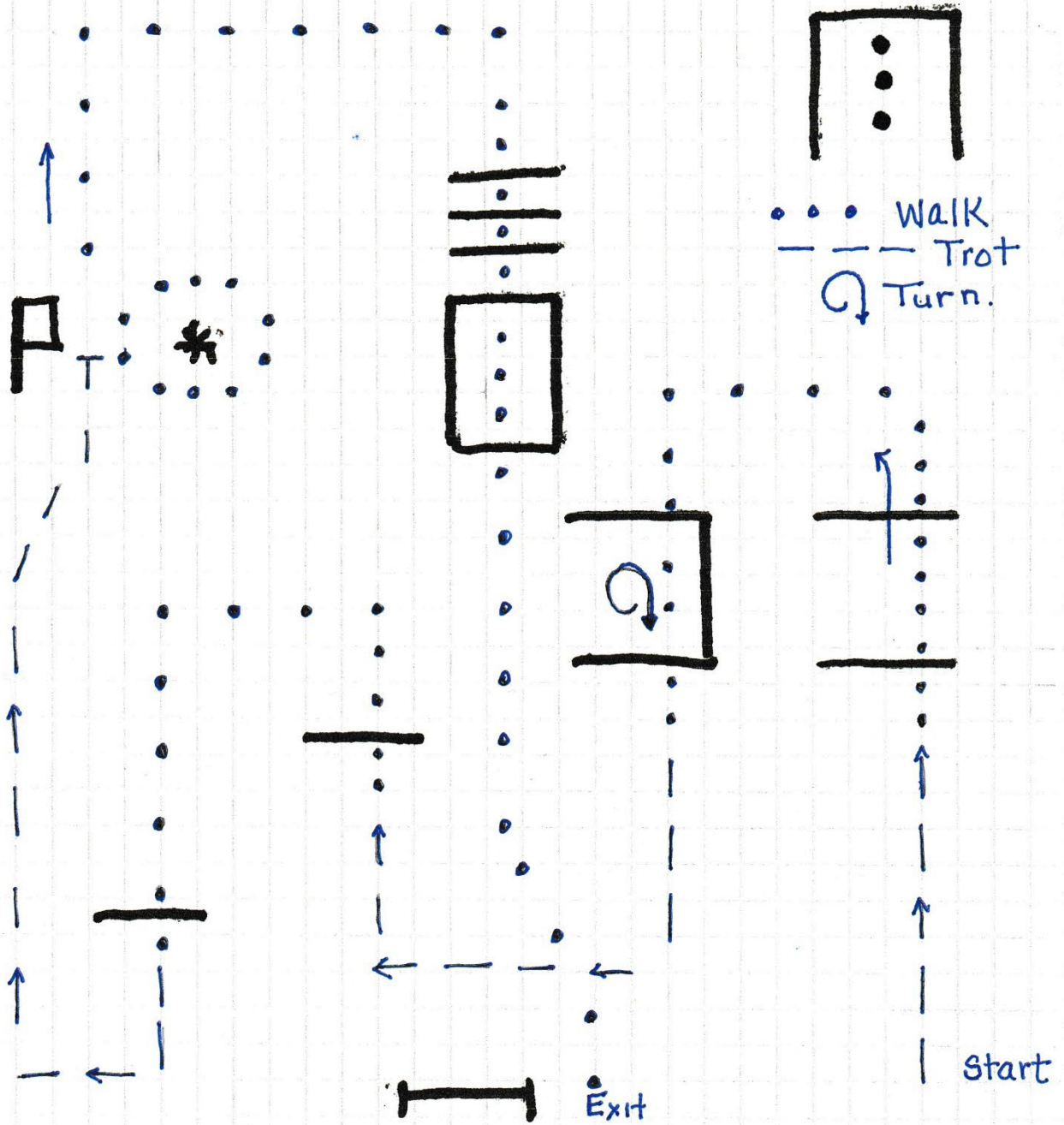

- * Trot to the 1st set of Logs. Walk over logs
- * Walk to the 2nd set of Logs walk over the 1st log, stop do 360 right walk out over the last log.
- * Trot to the next log, walk over that log and the next log.
- * Trot to mailbox, show mail, walk circle around cone.
- * Walk to next group of logs and Bridge, walk over logs, and bridge
And exit at the walk.

Trail Area All Showmanship

Classes 103, 107, 111, 115, 119
123, 127, 132, 137

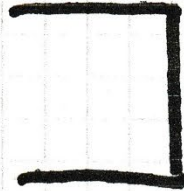
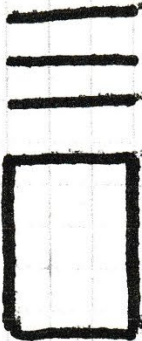
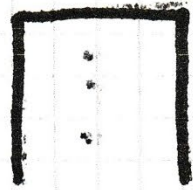

Start

Finish

Trot 1/2 way to Judge, Stop
Back 5 Steps. Walk to
Judge, Set up for inspection
After inspection do a 270
and Trot out.

Trail Area Class 131

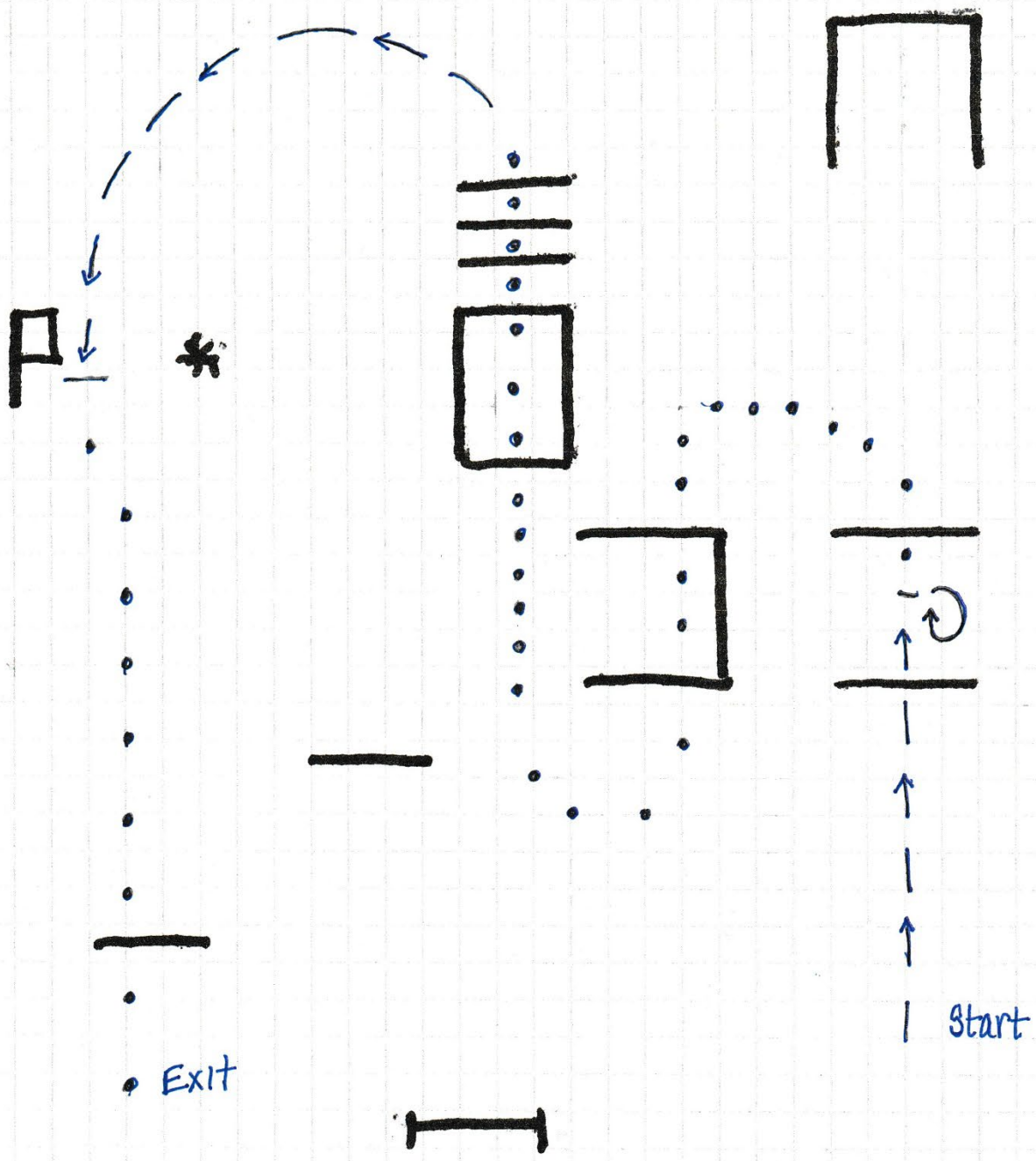

Trot into 1st Set of Logs
 Stop do 360 Right.
 Walk out and walk to and over
 the 2nd set of Logs.
 Walk to and over the Bridge and logs
 Trot to mailbox, show mail.
 Walk to and over the last log. Exit at a walk.



RANCH RIDING
 Pattern # 3
 WALK TROT

Class 48

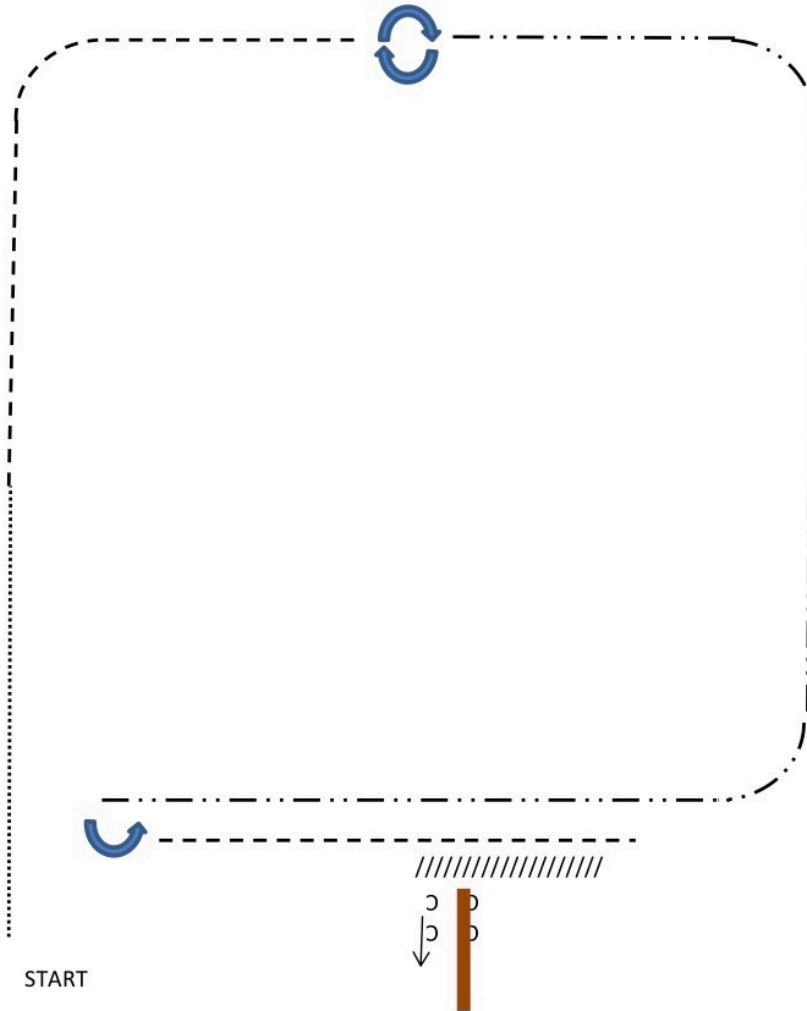

USE ONLY 1/2 of Arena

- | | |
|------------------|--------------------------|
| 1. Walk | 5. Stop, 180 Left |
| 2. Trot | 6. Trot, past center |
| 3. 360 Right | 7. Stop & Back to center |
| 4. Extended Trot | 8. Side Pass Rail Right |

WALK
TROT	-----
EXT TROT	-----